

**Sec. 1**

**CONSTRUCTION SCREWS**



Fastener For Sheet Metal To Structure  
 Tek<sup>®</sup> With Neo Bond<sup>®</sup> Washers  
 For Overlap  
 Structural Application

Steel Zinc Plated  
 Use Magnetic Chuck

Auveco Part No.	Size	Washer O.D.	Unit Pkg.
11205	#2 Tek <sup>®</sup> 12-14 x 1"	5/8"	50
11206	#3 Tek <sup>®</sup> 1/4-14 x 3/4"	5/8"	50

Do You Want Your Customers To  
 Know You Use The Best Body  
 Hardware & Specialty Fasteners  
 Available?

Promotional Products And Apparel  
 Bearing The  Logo Promote Your  
 Identity As A Professional.

**MACHINE SCREWS**

Listed According To Size



**Phillips Oval Head Machine Screws**

Size	Chrome Part No.	Zinc Part No.	Unit Pkg.
6-32 x 3/8"		16362	100
6-32 x 1/2"		16363	100
6-32 x 3/4"		16364	100
6-32 x 1-1/4"		16365	100
8-32 x 1/2"	2299	16368	100
8-32 x 3/4"		16369	100
8-32 x 3/4"	6 Hd. 1863		100
8-32 x 1"		16370	100
8-32 x 1-1/4"		16371	100
8-32 x 1-1/2"		16372	50
10-24 x 1/2"		1877	100
10-24 x 3/4"	1934	16375	100
10-24 x 1"		16376	100
10-24 x 1-1/4"		16377	100
10-24 x 1-1/2"		16378	100
10-32 x 3/8"		16379	100
10-32 x 1/2"		16380	100
10-32 x 3/4"		16381	100
10-32 x 1"	8 Hd. 1413		100
10-32 x 1"		16382	100
10-32 x 1-1/4"		16383	50
10-32 x 1-1/2"		16384	50
12-24 x 1/2"	16528		50
12-24 x 1"	16530		50
1/4-20 x 1/2"		16385	50
1/4-20 x 3/4"		16386	50
1/4-20 x 1"		16387	50
1/4-20 x 1-1/4"		16388	50
1/4-20 x 1-1/2"		16389	50



**Slotted Oval Head Machine Screws  
 Zinc Plated**

Auveco Part No.	Size	Unit Pkg.
2354	10-24 x 1-1/2"	100

# MACHINE SCREWS

Listed According To Size



## Phillips Pan Head Machine Screws

Zinc Plated

Auveco Part No.	Size	Unit Pkg.
15374.....	6-32 x 3/8"	100
15375.....	6-32 x 1/2"	100
15376.....	6-32 x 3/4"	100
15377.....	6-32 x 1"	100
15378.....	6-32 x 1-1/4"	100
15379.....	6-32 x 1-1/2"	100
15380.....	8-32 x 3/8"	100
15381.....	8-32 x 1/2"	100
15382.....	8-32 x 3/4"	100
15383.....	8-32 x 1"	100
15385.....	8-32 x 1-1/2"	100
15386.....	10-24 x 3/8"	100
15387.....	10-24 x 1/2"	100
15388.....	10-24 x 3/4"	100
15389.....	10-24 x 1"	100
15390.....	10-24 x 1-1/4"	100
15391.....	10-24 x 1-1/2"	50
15392.....	10-32 x 3/8"	100
15393.....	10-32 x 1/2"	100
15394.....	10-32 x 3/4"	100
15395.....	10-32 x 1"	100
15396.....	10-32 x 1-1/4"	100
15397.....	10-32 x 1-1/2"	50
15398.....	1/4-20 x 1/2"	100
15399.....	1/4-20 x 3/4"	100
15400.....	1/4-20 x 1"	50
15401.....	1/4-20 x 1-1/4"	50
15402.....	1/4-20 x 1-1/2"	50
15403.....	1/4-20 x 1-3/4"	50
15404.....	1/4-20 x 2"	50



## Slotted Round Head Machine Screws

Bright Zinc Chromate

Auveco Part No.	Size	Unit Pkg.
5700.....	6-32 x 3/8"	100
2530.....	6-32 x 1/2"	100
2531.....	6-32 x 3/4"	100
2532.....	6-32 x 1"	100
8588.....	6-32 x 1-1/2"	100
5702.....	8-32 x 3/8"	100
2533.....	8-32 x 1/2"	100
2534.....	8-32 x 3/4"	100
2535.....	8-32 x 1"	100
8589.....	8-32 x 1-1/2"	100
8590.....	10-32 x 3/8"	100
2536.....	10-32 x 1/2"	100
2537.....	10-32 x 3/4"	100
2538.....	10-32 x 1"	100
2539.....	10-32 x 1-1/4"	100
2540.....	10-32 x 1-1/2"	100
2541.....	10-24 x 1/2"	100
2542.....	10-24 x 3/4"	100
2543.....	10-24 x 1"	100
2544.....	10-24 x 1-1/4"	100
2545.....	10-24 x 1-1/2"	100
8594.....	10-24 x 2"	100
2546.....	12-24 x 1/2"	100
5704.....	12-24 x 3/4"	100
2548.....	12-24 x 1"	100
2550.....	12-24 x 1-1/2"	100
8029.....	1/4-20 x 1/2"	100
8030.....	1/4-20 x 3/4"	100
8031.....	1/4-20 x 1"	100
8033.....	1/4-20 x 1-1/2"	100
8035.....	1/4-20 x 2"	100
8036.....	1/4-20 x 2-1/2"	100



## Phillips Round Head Machine Screws

Zinc Plated

Auveco Part No.	Size	Unit Pkg.
16407.....	6-32 x 1/2"	100
16411.....	8-32 x 1"	100
16412.....	10-32 x 1/2"	100
16413.....	10-32 x 3/4"	100
16416.....	10-24 x 3/4"	100

For assortments of Slotted Round Head Machine Screws refer to Fix Kits 6011 and 6503 in the green pages.

You Can E-Mail your  
New Item Suggestions  
To [mail@auveco.com](mailto:mail@auveco.com)

## Sec. 2

# MACHINE SCREWS

Listed According To Size



Slotted Round Head Machine Screws  
Plain Brass

Auveco Part No.	Size	Unit Pkg.
3844	8-32 x 1/2"	100
3853	10-24 x 7/8"	100
3854	10-24 x 1"	100
3859	10-32 x 5/8"	100



Round Head Stove Bolts - Hex Nuts

Bright Zinc Chromate  
U.S.S. Coarse Thread

Auveco Part No.	Size	Unit Pkg.
5697	1/8 x 1"	100
3711	3/16 x 1/2"	100
3712	3/16 x 3/4"	100
3713	3/16 x 1"	100
3715	3/16 x 1-1/2"	100
3716	3/16 x 1-3/4"	100
3717	3/16 x 2"	100
3718	1/4 x 1/2"	100
3719	1/4 x 3/4"	100
3720	1/4 x 1"	100
3722	1/4 x 1-1/2"	100
3724	1/4 x 2"	100

Remember...

All Items Are Available In Bulk.

Call For A Quote.

# MISCELLANEOUS SCREWS

Listed According To Size



Carriage Bolts With Hex Nuts  
U.S.S. Coarse Thread • Zinc Plated • Grade 2

Auveco Part No.	Size	Unit Pkg.
9482	1/4 x 1"	50
9483	1/4 x 1-1/2"	50
9484	1/4 x 2"	50
9485	1/4 x 2-1/2"	50
9486	1/4 x 3"	50
9487	1/4 x 4"	25
9489	1/4 x 6"	25
9490	5/16 x 1"	50
9491	5/16 x 1-1/2"	50
9492	5/16 x 2"	25
9493	5/16 x 3"	25
9494	5/16 x 4"	25
9498	3/8 x 1"	25
9499	3/8 x 1-1/2"	25
9500	3/8 x 2"	25
9501	3/8 x 3"	25
9502	3/8 x 4"	25
9503	3/8 x 5"	25
9507	1/2 x 2"	10
9509	1/2 x 4"	10
9510	1/2 x 6"	10



Hex Washer Head Spin Lock Bolts

Black Phosphate • Grade 2

Auveco Part No.	Size	Hex	Washer Head O.D.	Unit Pkg.
2753*	1/4-20 x 5/8"	3/8"	5/8"	100
3615	5/16-18 x 3/4"	1/2"	13/16"	100
5711	5/16-18 x 1"	1/2"	13/16"	50
5713	5/16-18 x 1-1/4"	1/2"	13/16"	50
2688	5/16-24 x 1"	1/2"	13/16"	50
10296*	3/8-16 x 1"	9/16"	3/4"	50

\*Not Dog Point



## Socket Head Set Screws Cup Point



Auveco Part No.	Size	Unit Pkg.	Use Tool No.
5365	6-32 x 3/16"	50	5414
5366	6-32 x 1/4"	50	5414
5367	6-32 x 5/16"	50	5414
5368	6-32 x 3/8"	50	5414
5369	8-32 x 3/16"	50	5415
5370	8-32 x 1/4"	50	5415
5371	8-32 x 5/16"	50	5415
5372	8-32 x 3/8"	50	5415
5373	8-32 x 1/2"	50	5415

Part No. USS	Part No. SAE	Size	Unit Pkg.	Use Tool No.
--------------	--------------	------	-----------	--------------

**#10** U.S.S. (Coarse) Threads Per Inch: 24  
S.A.E. (Fine) Threads Per Inch: 32

5374	5394	10 x 3/16"	50
5375	5395	10 x 1/4"	50
5376	5396	10 x 5/16"	50
5377	5397	10 x 3/8"	50
5378	5398	10 x 1/2"	50

**1/4"** U.S.S. (Coarse) Threads Per Inch: 20  
S.A.E. (Fine) Threads Per Inch: 28

5379	5399	1/4 x 1/4"	50	5417
5380	5400	1/4 x 5/16"	50	5417
5381	5401	1/4 x 3/8"	50	5417
5382	5402	1/4 x 7/16"	50	5417
5383	5403	1/4 x 1/2"	50	5417

**5/16"** U.S.S. (Coarse) Threads Per Inch: 18  
S.A.E. (Fine) Threads Per Inch: 24

5384	5404	5/16 x 1/4"	50	7977*
5385	5405	5/16 x 5/16"	50	7977*
5386	5406	5/16 x 3/8"	50	7977*
5387	5407	5/16 x 7/16"	50	7977*
5388	5408	5/16 x 1/2"	50	7977*

Part No. USS	Part No. SAE	Size	Unit Pkg.	Use Tool No.
--------------	--------------	------	-----------	--------------

**3/8"**

U.S.S. (Coarse) Threads Per Inch: 16  
S.A.E. (Fine) Threads Per Inch: 24

5389	5409	3/8 x 5/16"	25	7978*
5390	5410	3/8 x 3/8"	25	7978*
5391	5411	3/8 x 7/16"	25	7978*
5392	5412	3/8 x 1/2"	25	7978*
5393	5413	3/8 x 5/8"	25	7978*

**7/16"**

U.S.S. (Coarse) Threads Per Inch: 14  
S.A.E. (Fine) Threads Per Inch: 20

15898	15905	7/16 x 3/8"	25	7978*
-------	-------	-------------	----	-------

**1/2"**

U.S.S. (Coarse) Threads Per Inch: 13  
S.A.E. (Fine) Threads Per Inch: 20

15901	15907	1/2 x 3/8"	25	7978*
15902		1/2 x 7/16"	25	7978*
15903	15909	1/2 x 1/2"	25	7978*
15904	15910	1/2 x 5/8"	25	7978*

\*Fold-up Key Set

Note: All Socket Wrenches packed 10 per Unit Package except Key Sets 7977 & 7978 which are packed 1 per Unit Package

For an assortment of Socket Head Set Screws, see Fix-Kit No. 6073 in the green pages.

# GRADE 8 HEX FLANGE PRODUCT FOR FRAME BOLTING

All Items Phosphate & Oil

Auveco flange bolts and locknuts form a strong and dependable fastening system that substantially cuts truck assembly, maintenance and repair costs. The flange bolts are made of IFI 111 industry standard specifications, and when used in conjunction with the flange locknuts form a 150,000 P.S.I. tensile strength fastening system equivalent to SAE J429, Grade 8 industry standard specification. Flat washers and lock washers are not needed with the flange bolts. Also our flange fastening system reduces the need for costly hole preparations such as deburring and countersinking.

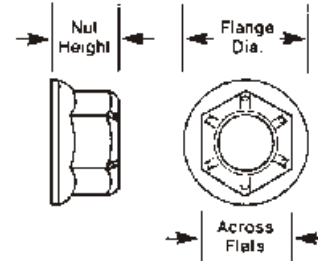
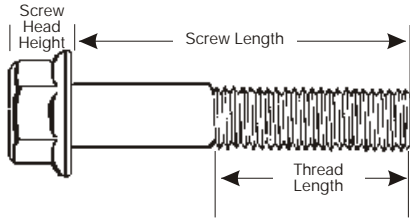

## Product Specifications

Product Diameter	Flange & Nut Diameter	Screw & Nut Across Flats	Screw Head Height	Nut Height	Minimum Screw Thread Length
3/8"	.780"/.810"	.551"/.562"	.370"/.390"	.415"/.425"	1"
1/2"	1.031"/1.070"	.736"/.750"	.490"/.510"	.545"/.555"	1-1/4"
5/8"	1.300"/1.330"	.922"/.937"	.600"/.620"	.680"/.690"	1-1/2"
3/4"	1.510"/1.565"	1.110"/1.125"	.710"/.730"	.740"/.750"	1-3/4"

## Grade 8 Hex Flange Bolts

Size	Auveco Part No. U.S.S.	U.S.S. Unit Pkg.	Auveco Part No. S.A.E.	S.A.E. Unit Pkg.	Size	Auveco Part No. U.S.S.	U.S.S. Unit Pkg.	Auveco Part No. S.A.E.	S.A.E. Unit Pkg.
<b>3/8"</b>	U.S.S. Coarse Threads Per Inch: 16				<b>5/8"</b>	S.A.E. (Fine) Threads Per Inch: 18 U.S.S. (Coarse) Threads Per Inch: 11			
3/8" x 1"	17561*	25	.....	...	5/8 x 1-1/2"	17576*	10	14493*	10
3/8" x 1-1/4"	17562*	25	.....	...	5/8 x 1-3/4"	17577*	10	14494*	10
3/8" x 1-1/2"	17563	25	.....	...	5/8 x 2"	17578*	10	14495*	10
3/8" x 1-3/4"	17564	25	.....	...	5/8 x 2-1/4"	17579*	10	14496*	10
<b>1/2"</b>	S.A.E. (Fine) Threads Per Inch: 20 U.S.S. (Coarse) Threads Per Inch: 13				5/8 x 2-1/2"	17580	10	14497	10
1/2 x 1"	17565*	25	14487*	10	5/8 x 2-3/4"	.....	.....	14498	10
1/2 x 1-1/4"	17566*	25	.....	...	5/8 x 3"	17582	10	14499	10
1/2 x 1-1/2"	17567*	25	14489*	10	5/8 x 3-1/4"	17583	10	.....	...
1/2 x 1-3/4"	17568*	25	14490*	10	5/8 x 3-1/2"	17584	10	.....	...
1/2 x 2"	17569	15	14491	10	*Items Threaded To The Head				
1/2 x 2-1/4"	17570	15	.....	...					
1/2 x 2-1/2"	17571	15	.....	...					
1/2 x 3"	17573	15	.....	...					
1/2 x 3-1/4"	17574	15	.....	...					
1/2 x 3-1/2"	17575	15	.....	...					

## Hex Flange Locknuts

Part Number	Size	Unit Pkg.	Part Number	Size	Unit Pkg.
12517	3/8-16 (Coarse)	50	12519	5/8-11 (Coarse)	25
12518	1/2-13 (Coarse)	25	14501	5/8-18 (Fine)	25
14500	1/2-20 (Fine)	25	15180	3/4-10 (Coarse)	10

CAP SCREWS



Grade 5

Bright Zinc Chromate  
Medium Carbon Heat Treated Steel  
120,000 P.S.I. Minimum Tensile Strength  
Head is Identified With 3 Radial Lines

Size	Part No. USS	Part No. SAE	Unit Pkg.
<b>1/4"</b> U.S.S. (Coarse) Threads Per Inch: 20 S.A.E. (Fine) Threads Per Inch: 28			
1/4 x 1/2"	*5434	*5495	100
1/4 x 5/8"	*5435		100
1/4 x 3/4"	*5436	*5497	100
1/4 x 1"	*5438	*5499	100
1/4 x 1-1/4"	5439	5500	100
1/4 x 1-1/2"	5440	5501	100
1/4 x 1-3/4"	5441		100
1/4 x 2"	5442		100
1/4 x 2-1/4"	5443		100
1/4 x 2-1/2"	5444	5505	100
1/4 x 2-3/4"	5445		100
1/4 x 3"	5446		100
1/4 x 3-1/2"	8449		100
<b>5/16"</b> U.S.S. (Coarse) Threads Per Inch: 18 S.A.E. (Fine) Threads Per Inch: 24			
5/16 x 1/2"	*5447		100
5/16 x 5/8"	*5448		100
5/16 x 3/4"	*5449	*5510	100
5/16 x 7/8"	*5450		100
5/16 x 1"	*5451	*5512	100
5/16 x 1-1/4"	*5452	*5513	100
5/16 x 1-1/2"	5453	5514	100
5/16 x 1-3/4"	5454		100
5/16 x 2"	5455	5516	50
5/16 x 2-1/4"	5456		50
5/16 x 2-1/2"	5457		50
5/16 x 3"	5459		50
5/16 x 3-1/2"	5461		50
5/16 x 4"	8450		50
<b>3/8"</b> U.S.S. (Coarse) Threads Per Inch: 16 S.A.E. (Fine) Threads Per Inch: 24			
3/8 x 5/8"	*5462		50
3/8 x 3/4"	*5463	*5524	50
3/8 x 7/8"	*5464		50
3/8 x 1"	*5465	*5526	50
3/8 x 1-1/4"	*5466	*5527	50
3/8 x 1-1/2"	5467	5528	50
3/8 x 1-3/4"	5468		50
3/8 x 2"	5469	5530	50
3/8 x 2-1/4"	5470		50
3/8 x 2-1/2"	5471		50
3/8 x 3"	5472	5533	50
3/8 x 3-1/2"	5473		50
3/8 x 4"	5474		50
3/8 x 4-1/2"	8096		25
3/8 x 5"	8097		25

\*Items Threaded To Head



Grade 5

Bright Zinc Chromate  
Medium Carbon Heat Treated Steel  
120,000 P.S.I. Minimum Tensile Strength  
Head is Identified With 3 Radial Lines

Size	Part No. USS	Part No. SAE	Unit Pkg.
<b>7/16"</b> U.S.S. (Coarse) Threads Per Inch: 14 S.A.E. (Fine) Threads Per Inch: 20			
7/16 x 3/4"	*5475		50
7/16 x 1"	*5476	*5537	50
7/16 x 1-1/4"	*5477	*5538	50
7/16 x 1-1/2"	*5478	*5539	50
7/16 x 1-3/4"	5479		50
7/16 x 2"	5480		25
7/16 x 2-1/2"	5481	5542	25
7/16 x 3"	5482		25
7/16 x 3-1/2"	5483		25
7/16 x 4"	5484		25
<b>1/2"</b> U.S.S. (Coarse) Threads Per Inch: 13 S.A.E. (Fine) Threads Per Inch: 20			
1/2 x 3/4"	*5485		50
1/2 x 1"	*5486	*5547	50
1/2 x 1-1/4"	*5487		50
1/2 x 1-1/2"	*5488		25
1/2 x 1-3/4"	*5489	*5550	25
1/2 x 2"	5490	5551	25
1/2 x 2-1/2"	5491	5552	25
1/2 x 3"	5492	5553	25
1/2 x 3-1/2"	5493		25
1/2 x 4"	5494		25
1/2 x 4-1/2"	8104		25
1/2 x 5"	8105		25
1/2 x 6"	8107		25
<b>5/8"</b> U.S.S. (Coarse) Threads Per Inch: 11 S.A.E. (Fine) Threads Per Inch: 18			
5/8 x 1"	*9520		25
5/8 x 1-1/2"	*9521	*9528	25
5/8 x 2"	*9522	*9529	25
5/8 x 2-1/2"	9523		25
5/8 x 3"	9524		25
5/8 x 3-1/2"	9525		25
5/8 x 4"	9526		25
<b>3/4"</b> U.S.S. (Coarse) Threads Per Inch: 10			
3/4 x 2"	*8453		10
3/4 x 2-1/2"	*8454		10
3/4 x 3"	8455		10
3/4 x 3-1/2"	8456		10
3/4 x 5"	8459		10

\*Items Threaded To Head

Refer to Assortment 1020 in the green pages

CAP SCREWS



Grade 8

Zinc & Yellow Dichromate  
Medium Carbon Alloy Steel

150,000 P.S.I. Minimum Tensile Strength  
Head Is Identified With 6 Radial Lines

Size	Part No. USS	Part No. SAE	Unit Pkg.
<b>1/4"</b>	U.S.S. (Coarse) Threads Per Inch: 20 S.A.E. (Fine) Threads Per Inch: 28		
1/4 x 1/2"	*9118		50
1/4 x 3/4"	*9119	*9174	50
1/4 x 1"	*9120		50
1/4 x 1-1/4"	9121		50
1/4 x 1-1/2"	9122	9177	50
1/4 x 2"	9124		50
1/4 x 2-1/4"	9125		25
1/4 x 2-1/2"	9126		25

<b>5/16"</b>	U.S.S. (Coarse) Threads Per Inch: 18 S.A.E. (Fine) Threads Per Inch: 24		
5/16 x 1/2"	*9127		50
5/16 x 3/4"	*9128		50
5/16 x 1"	*9129	*9184	50
5/16 x 1-1/4"	*9130		50
5/16 x 1-1/2"	9131	9186	50
5/16 x 1-3/4"	9132		50
5/16 x 2"	9133	9188	50
5/16 x 2-1/2"	9134		25
5/16 x 3"	9135		25
5/16 x 5"	17030		10

<b>3/8"</b>	U.S.S. (Coarse) Threads Per Inch: 16 S.A.E. (Fine) Threads Per Inch: 24		
3/8 x 3/4"	*9136	*9191	50
3/8 x 1"	*9137	*9192	50
3/8 x 1-1/4"	*9138	*9193	50
3/8 x 1-1/2"	9139	*9194	50
3/8 x 2"	9140		25
3/8 x 2-1/2"	9141		25
3/8 x 3"	9142		25
3/8 x 3-1/2"	17028		15
3/8 x 4"	9143		25

\*Items Threaded To Head



Grade 8

Zinc & Yellow Dichromate  
Medium Carbon Alloy Steel

150,000 P.S.I. Minimum Tensile Strength  
Head Is Identified With 6 Radial Lines

Size	Part No. USS	Part No. SAE	Unit Pkg.
<b>7/16"</b>	U.S.S. (Coarse) Threads Per Inch: 14 S.A.E. (Fine) Threads Per Inch: 20		
7/16 x 1"	*9144	*9199	25
7/16 x 1-1/4"	*9145		25
7/16 x 1-1/2"	*9146	*9201	25
7/16 x 2"	9147		25
7/16 x 2-1/2"	9148	9203	25
7/16 x 3"	9149		25
7/16 x 4"	9150		25
7/16 x 5-1/2"	17031		10
<b>1/2"</b>	U.S.S. (Coarse) Threads Per Inch: 13 S.A.E. (Fine) Threads Per Inch: 20		
1/2 x 1"	*9151		25
1/2 x 1-1/4"	*9152		25
1/2 x 1-1/2"	*9153	*9208	25
1/2 x 1-3/4"	*9154	*9209	25
1/2 x 2"	9155	9210	25
1/2 x 2-1/2"	9156		25
1/2 x 2-3/4"		17983	10
1/2 x 3"	9157	9212	10
1/2 x 4"	9158	9213	10
1/2 x 5"	9159		10
<b>5/8"</b>	U.S.S. (Coarse) Threads Per Inch: 11 S.A.E. (Fine) Threads Per Inch: 18		
5/8 x 1-1/2"	*9160		10
5/8 x 2"	*9161		10
5/8 x 2-1/2"	9162		10
5/8 x 3"	9163		10
5/8 x 3-1/2"	17499		10
5/8 x 4"	9164	9219	10
5/8 x 5"	9165		10
<b>3/4"</b>	U.S.S. (Coarse) Threads Per Inch: 10 S.A.E. (Fine) Threads Per Inch: 16		
3/4 x 2"	*9167		10
3/4 x 3"	9169	9224	10
3/4 x 3-1/2"	9170		10
3/4 x 4"	9171		10
3/4 x 5"	9172		10

\* Items Threaded to Head

Refer to Assortment 1030 in the green pages

# STAINLESS STEEL

18-8 (300 SERIES)

Sec. 2



Stainless Steel Phillips  
Pan Head Tapping Screws

Auveco Part No.	Size	Unit Pkg.
13265	6 x 1/2"	100
13266	6 x 3/4"	100
13267	6 x 1"	100
13268	6 x 1-1/4"	100
13269	8 x 1/2"	100
13270	8 x 3/4"	50
13271	8 x 1"	50
13272	8 x 1-1/4"	50
13273	8 x 1-1/2"	25
13274	10 x 1/2"	100
13275	10 x 3/4"	50
13276	10 x 1"	50
13277	10 x 1-1/4"	50
13278	10 x 1-1/2"	25
13279	10 x 1-3/4"	25
13280	12 x 1/2"	50
13281	12 x 3/4"	50
13282	12 x 1"	50
13283	12 x 1-1/4"	25
13284	12 x 1-1/2"	25



Stainless Steel Phillips  
Oval Head Tapping Screws

Auveco Part No.	Size	Unit Pkg.
9399	6 x 1/2"	100
9400	6 x 3/4"	100
9401	6 x 1"	100
9402	6 x 1-1/4"	100
9403	8 x 1/2"	100
9404	8 x 3/4"	100
9405	8 x 1"	100
9406	8 x 1-1/4"	100
9407	8 x 1-1/2"	100
9408	10 x 1/2"	100
9409	10 x 3/4"	100
9410	10 x 1"	100
9411	10 x 1-1/4"	100
9412	10 x 1-1/2"	100
13286	10 x 1-3/4"	25
13288	12 x 3/4"	50
13289	12 x 1"	50
13290	12 x 1-1/4"	25
13291	12 x 1-1/2"	25
13292	12 x 1-3/4"	25



Stainless Steel Slotted  
Round Head Machine Screws

Auveco Part No.	Size	Unit Pkg.
13293	6-32 x 1/4"	100
13294	6-32 x 1/2"	100
13295	6-32 x 3/4"	100
13296	6-32 x 1"	100
13298	8-32 x 1/4"	100
13299	8-32 x 1/2"	100
13300	8-32 x 3/4"	100
13301	8-32 x 1"	100
13302	8-32 x 1-1/4"	50
13304	10-24 x 1/2"	100
13305	10-24 x 3/4"	100
13306	10-24 x 1"	50
13308	10-24 x 1-1/2"	50
13310	10-32 x 1/2"	100
13311	10-32 x 3/4"	100
13312	10-32 x 1"	50
13314	10-32 x 1-1/2"	50
13316	1/4-20 x 3/4"	50
13318	1/4-20 x 1-1/4"	25
13319	1/4-20 x 1-1/2"	25
13320	1/4-20 x 1-3/4"	25



Stainless Steel Phillips Oval Head  
Machine Screws

Auveco Part No.	Size	Unit Pkg.
13322	6-32 x 1/2"	100
13323	6-32 x 3/4"	100
13324	6-32 x 1"	100
13325	6-32 x 1-1/4"	100
13326	8-32 x 1/4"	100
13327	8-32 x 1/2"	100
13328	8-32 x 3/4"	100
13329	8-32 x 1"	100
13330	8-32 x 1-1/4"	50
13331	10-24 x 1/2"	100
13332	10-24 x 3/4"	50
13333	10-24 x 1"	50
13334	10-24 x 1-1/4"	50
13335	10-24 x 1-1/2"	50
13336	10-32 x 1/2"	100
13337	10-32 x 3/4"	50
13338	10-32 x 1"	50
13339	10-32 x 1-1/4"	50
13340	10-32 x 1-1/2"	50
13341	1/4-20 x 1/2"	50
13342	1/4-20 x 3/4"	50
13343	1/4-20 x 1"	25
13344	1/4-20 x 1-1/4"	25
13345	1/4-20 x 1-1/2"	25



# STAINLESS STEEL

18-8 (300 SERIES)



## U.S.S. Coarse Thread Stainless Steel Hex Head Cap Screws

Auveco Part No.	Bolt Size	Unit Pkg.	Auveco Part No.	Bolt Size	Unit Pkg.
* 13346	1/4-20 x 1/2"	50	13369	3/8-16 x 2-1/4"	25
* 13347	1/4-20 x 3/4"	50	13370	3/8-16 x 2-1/2"	25
13348	1/4-20 x 1"	50	13391	3/8-16 x 3"	25
13349	1/4-20 x 1-1/4"	50			
13350	1/4-20 x 1-1/2"	50	* 13373	1/2-13 x 1"	10
13351	1/4-20 x 1-3/4"	25	* 13374	1/2-13 x 1-1/4"	10
13352	1/4-20 x 2"	25	13375	1/2-13 x 1-1/2"	10
			13377	1/2-13 x 2"	10
* 13353	5/16-18 x 1/2"	50	13379	1/2-13 x 2-1/2"	10
* 13354	5/16-18 x 3/4"	25			
13355	5/16-18 x 1"	25	13385	5/8-11 x 1-3/4"	10
13356	5/16-18 x 1-1/4"	25	13386	5/8-11 x 2"	10
13357	5/16-18 x 1-1/2"	25			
13358	5/16-18 x 1-3/4"	25			
13359	5/16-18 x 2"	25			
13360	5/16-18 x 2-1/4"	25			
13361	5/16-18 x 2-1/2"	25			
* 13362	3/8-16 x 1/2"	50			
* 13363	3/8-16 x 3/4"	50			
* 13364	3/8-16 x 1"	50			
13365	3/8-16 x 1-1/4"	25			
13366	3/8-16 x 1-1/2"	25			
13367	3/8-16 x 1-3/4"	25			
13368	3/8-16 x 2"	25			

\* Items Threaded To Head



## Stainless Steel Cotter Pins Extended Prong Type

Auveco Part No.	Size	Rec. Hole Size	Unit Pkg.	Auveco Part No.	Size	Rec. Hole Size	Unit Pkg.
13409	1/16 x 3/4"	.078	100	13422	1/8 x 1-1/2"	.141	50
13410	1/16 x 1"	.078	100	13423	1/8 x 1-3/4"	.141	25
				13424	1/8 x 2"	.141	25
13411	3/32 x 1/2"	.109	100	13426	1/8 x 2-1/2"	.141	25
13412	3/32 x 3/4"	.109	100				
13413	3/32 x 1"	.109	100	13428	5/32 x 1"	.172	50
13414	3/32 x 1-1/4"	.109	50	13429	5/32 x 1-1/4"	.172	50
13415	3/32 x 1-1/2"	.109	50	13430	5/32 x 1-1/2"	.172	25
13416	3/32 x 1-3/4"	.109	50	13431	5/32 x 1-3/4"	.172	25
13417	3/32 x 2"	.109	50	13432	5/32 x 2"	.172	25
				13434	5/32 x 2-1/2"	.172	25
13419	1/8 x 3/4"	.141	100				
13420	1/8 x 1"	.141	50				
13421	1/8 x 1-1/4"	.141	50				

# STAINLESS STEEL

18-8 (300 SERIES)

## Stainless Steel Wing Nuts

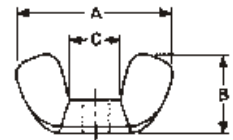

Auveco Part No.	Size	Wing Spread (A)		Overall Height (B)		Between Wing (c)		Unit Pkg.
		Max.	Min.	Max.	Min.	Max.	Min.	
13255	8-32	.91	.78	.47	.34	.27	.22	25
13256	10-24	.91	.78	.47	.34	.27	.22	25
13258	1/4-20	1.10	.97	.57	.43	.39	.26	25
13259	5/16-18	1.25	1.12	.66	.53	.39	.32	10



## Stainless Steel Hex Machine Screw Nuts

Auveco Part No.	Size	Hex Width	Unit Pkg.
13260	6-32	5/16"	100
13261	8-32	11/32"	100
13262	10-24	3/8"	100
13263	10-32	3/8"	100
13264	1/4-20	7/16"	100

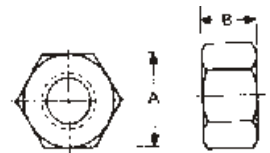

## Stainless Steel Hex Nuts

Auveco Part No.	Size	Hex Width (A)	Thickness (B)	Unit Pkg.
13234	1/4-20	7/16"	7/32"	100
13235	5/16-18	1/2"	17/64"	50
13236	3/8-16	9/16"	21/64"	50
13237	1/2-13	3/4"	7/16"	25



## Stainless Steel Acorn Nuts

Auveco Part No.	Size	Hex Width	Unit Pkg.
13248	6-32	5/16"	25
13249	8-32	5/16"	25
13250	10-24	3/8"	25
13251	10-32	3/8"	25
13252	1/4-20	7/16"	25
13253	5/16-18	9/16"	10



## Stainless Steel Nylon Insert Lock Nuts

Auveco Part No.	Size	Hex Width	Unit Pkg.
13239	6-32	5/16"	50
13240	8-32	11/32"	50
13241	10-24	3/8"	50
13242	10-32	3/8"	50
13243	1/4-20	7/16"	50
13244	5/16-18	1/2"	25
13245	3/8-16	9/16"	25
13246	1/2-13	3/4"	10

# STAINLESS STEEL

18-8 (300 SERIES)

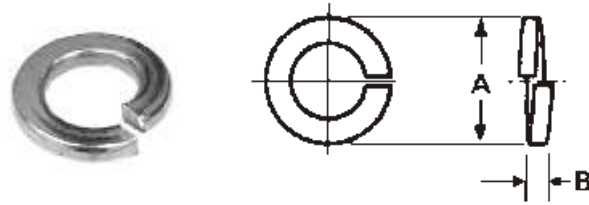

Stainless Steel Medium Split Washers

Auveco Part No.	Size	O.D. (A)	Minimum Thickness (B)	Unit Pkg.
13400	No. 6 or 1/8"	1/4"	.031	100
13401	No. 8	19/64"	.040	100
13402	No. 10 or 3/16"	21/64"	.047	100
13403	1/4"	31/64"	.062	100
13404	5/16"	19/32"	.078	100
13405	3/8"	11/16"	.094	100
13406	1/2"	7/8"	.125	50

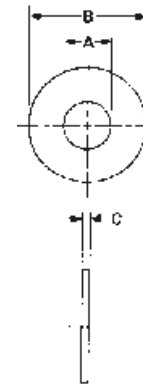

Stainless Steel Commercial Flat Washers

Auveco Part No.	Bolt Size	I.D. (A)	O.D. (B)	Approximate Thickness (C)	Unit Pkg.
13392	No. 6 or 1/8"	9/64"	3/8"	.030	100
13393	No. 8	5/32"	3/8"	.030	100
13394	No. 10 or 3/16"	7/32"	7/16"	.030	100
13395	1/4"	9/32"	5/8"	.043	100
13396	5/16"	11/32"	3/4"	.050	100
13397	3/8"	13/32"	7/8"	.060	50
13398	1/2"	33/64"	1-1/4"	.060	50